

ITEM NO.	PART NUMBER	DESCRIPTION	QTY.
1	1793D	CART. BASE, CD	1
2	1213-PPRO	FOOT, ANGLE, SKID FRAME	4
3	613-PPRO	2-1/2" RUBBER FOOT	4
4	111 037 500 100	FLAT WASHER, USS, 3/8	8
5	105 061 601 500	HHCS, USS, GR5, 3/8-16 X 1-1/2"	4
6	130 061 600 000	NYLOCK NUT, USS, 3/8-16	4
7	2760-PPRO	GROMMET, BLACK FOR 3/16 METAL	5
8	21157	RHSNBOLT 0.25-20X1.25X1.25-S	8
9	111 025 000 100	FLAT WASHER, USS, 1/4	8
10	130 042 000 000	NYLOCK NUT, USS 1/4-20	8
11	PDE-TIPS	DECAL, MULTI COLOR, TIPS	1

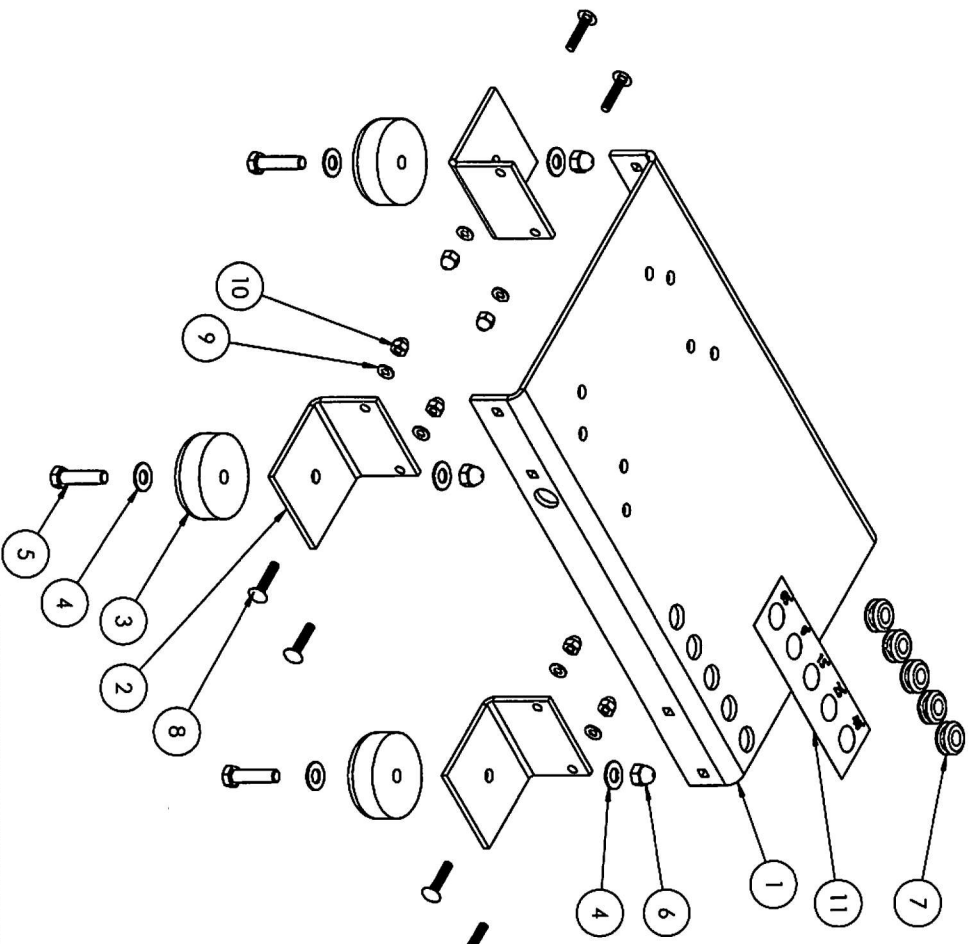

PROHIBIT AND CONFIDENTIAL
 THE INFORMATION CONTAINED IN THIS DRAWING IS THE SOLE PROPERTY OF SHARP CORPORATION AND IS TO BE USED FOR THE PURPOSES SPECIFIED HEREIN. WITHOUT THE WRITTEN PERMISSION OF SHARP CORPORATION, REPRODUCTION OR TRANSMISSION OF THIS INFORMATION IS PROHIBITED.

UNLESS OTHERWISE SPECIFIED:		NAME	DATE	TITLE:
DIMENSIONS ARE IN INCHES	TOLERANCES: ± 0.010	DRAWN	CHECKED	
ANGULAR MATCH	BEND 3.1°	DWG APPR.	DWG APPR.	
TWO PLACE DECIMAL, ±0.010	THREE PLACE DECIMAL, ±0.005	MFG APPR.	MFG APPR.	
INTERIOR GEOMETRIC TOLERANCING PER:	O.A.	COMMENTS:		
MATERIAL:		DEBURR ALL SHARP EDGES		
FINISH:				
DO NOT SCALE DRAWING				
SIZE: DWG. NO. B KCA075	REV			
SHEET 1 OF 1				